

# Split EMI Suppression Cores (CF Series)

## Description :

Split EMI Suppression Core (CF Series) consists with a nylon plastic case and two half ferrite cores. It can be installed to cable easily so don't need cut the existing cable firstly and can be removed from cable without damage. Due to this feature, it can be installed after assembly products to save the time before marketing. If the design need higher impedance, increase the wire turns through the core is a fast and easy solution.



## Applications :

- Suppress high frequency noise from cables to compliance with FCC, VDE and VCCI.
- Suitable for various power / signal cables inside or outside the equipments.
- Widespread use for electric equipments like NBs, PCs, monitors, printers, digital cameras, power suppls, DVD players, fax machines, medical equipments, internet wire, and etc.

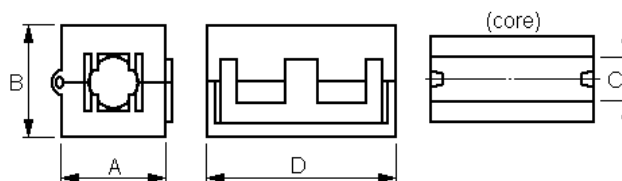

Part Number	A (mm)	B (mm)	C (mm)	D (mm)	Typical Impedance (ohm)		Z-F Fig.
					25MHz	100MHz	
CF-65S	17.8	19.5	6.5	32.5	171	325	1
CF-100S	22.3	23.3	10.0	32.6	136	250	2
CF-130S	29.6	30.5	13.0	33.0	150	250	3

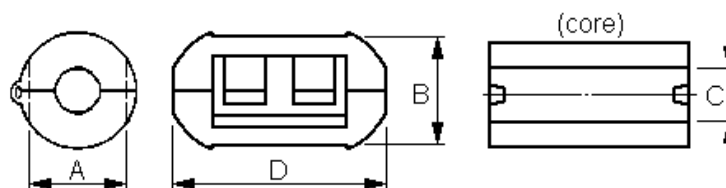

Part Number	A (mm)	B (mm)	C (mm)	D (mm)	Typical Impedance (ohm)		Z-F Fig.
					25MHz	100MHz	
CF-35R	12.8	14.7	4.0	25.0	79	143	4
CF-50R	14.5	15.7	5.6	29.0	69	150	5
CF-75R	18.9	20.7	7.0	39.1	108	286	6

# Split EMI Suppression Cores (CF Series)

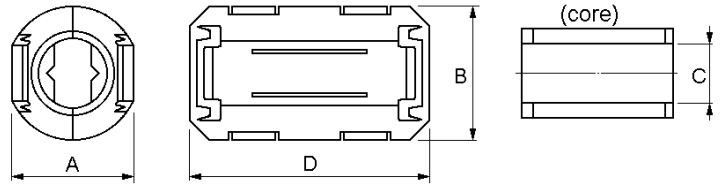

Part Number	A (mm)	B (mm)	C (mm)	D (mm)	Typical Impedance (ohm)		Z-F Fig.
					25MHz	100MHz	
CF-35M	11.7	13.0	3.5	25.0	136	186	4
CF-50M	11.7	13.0	5.0	25.0	93	150	5
CF-70M	14.8	17.0	7.0	30.0	79	157	6
CF-90M	18.0	19.7	9.0	35.0	89	170	7

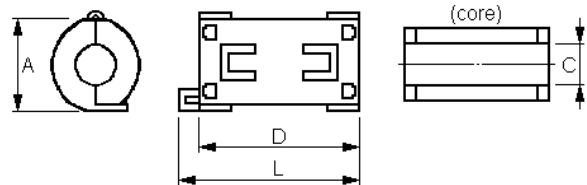

Part Number	A (mm)	C (mm)	D (mm)	L (mm)	Typical Impedance (ohm)		Z-F Fig.
					25MHz	100MHz	
CF-70A	14.3	7.3	18.1	22.2	47	100	6
CF-90A	18.6	9.0	31.0	35.2	89	170	7
CF-110A	20.1	11.1	32.0	36.1	67	100	8
CF-130A	29.5	13.0	34.0	39.2	125	220	3

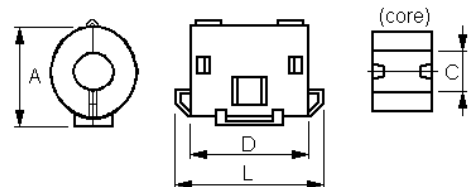

Part Number	A (mm)	C (mm)	D (mm)	L (mm)	Typical Impedance (ohm)		Z-F Fig.
					25MHz	100MHz	
CF-80U1	21.5	8.15	16.8	23.0	40	95	9
CF-80U2	21.5	8.15	19.7	25.8	50	105	9
CF-115U	30.5	11.4	17.7	24.0	50	100	8
CF-150U	31.5	15.0	15.2	21.5	40	90	8

# Split EMI Suppression Cores (CF Series)

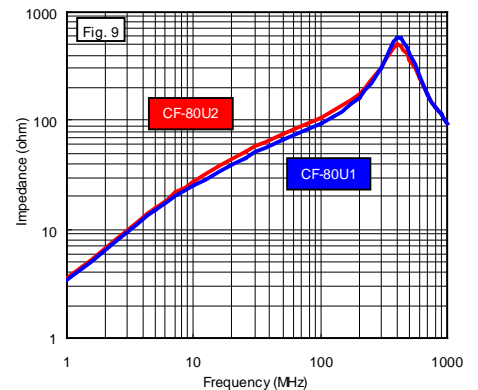
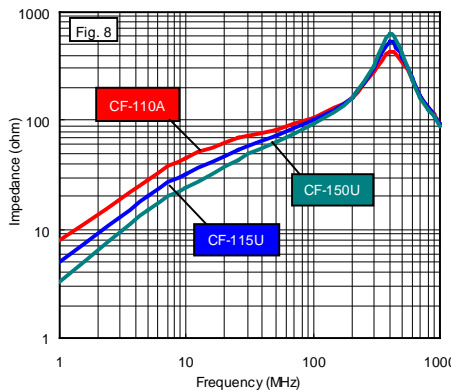
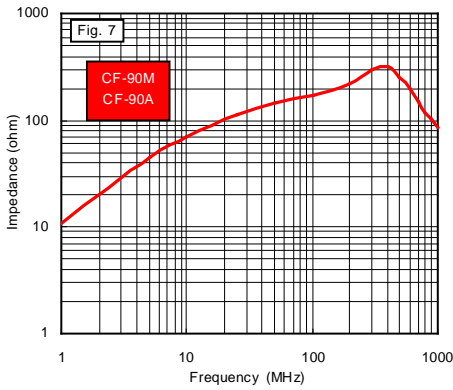
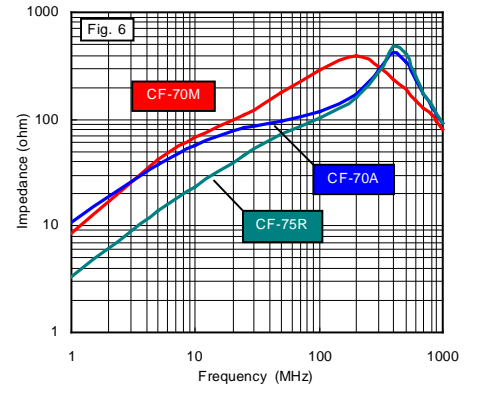
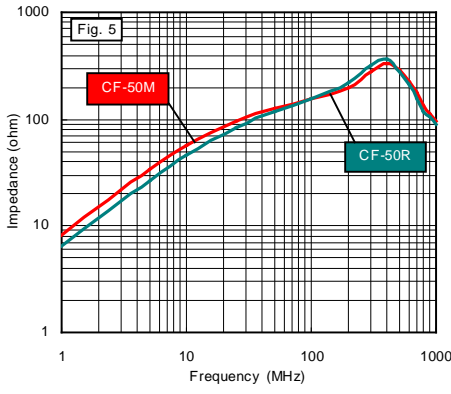
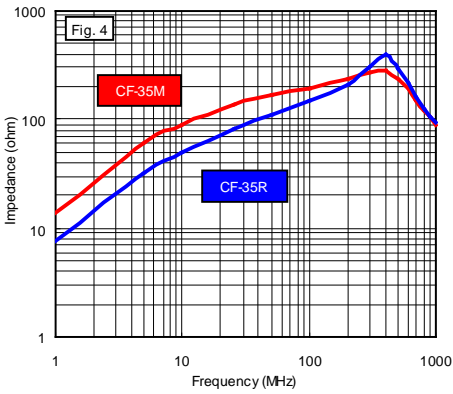
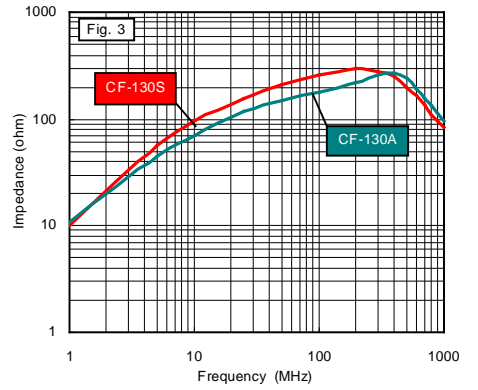
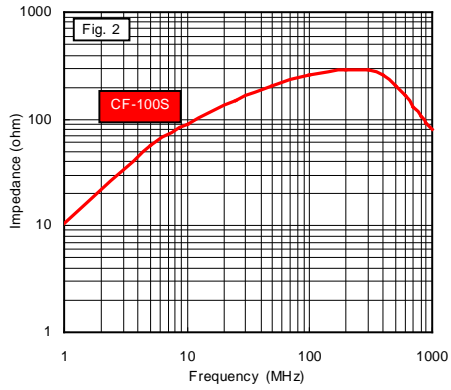
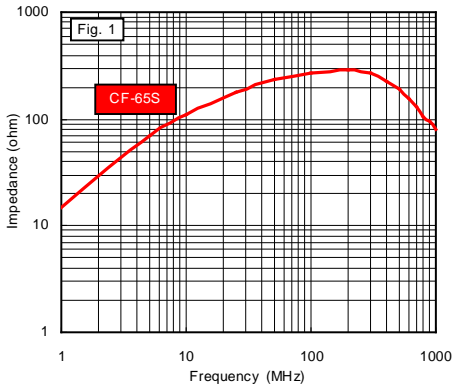

Note : 1. Above test condition is a diameter 1.0mm with 10cm length wire through the core to compare the impedance for reference.  
 2. For actually application, the wire length and diameter is different and impedance reading will not the same.

